



# Model 3800 Concealed Thermostatic Shower Valve Eng. No. 73047 (1/2" & 3/4")

Concealed thermostatically-controlled mixing valve with satin stainless steel trim and lever handle.

The Lawler thermostatically-controlled mixing valve has a solid liquid-filled thermostat. The valve has lead free brass body construction with replaceable corrosion resistant components. The piston and liner are constructed of stainless steel material. The mixing valve has integral shut-off and is adjustable from cold to 115°F unless otherwise specified. The valve employs an adjustable temperature limit stop.

The wall trim has a satin stainless steel finish with a solid brass, polished chrome lever handle. ADA compliant

FLOW CAPACITIES SINGLE STAGE - SERIES 3000 3500 3800 & 3900

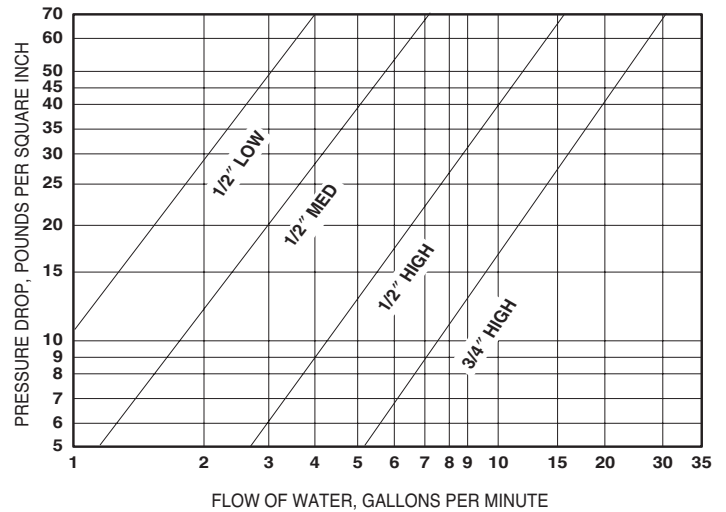

Standard valve is 1/2" medium flow

**OPTIONS:**

- Suffix VR – Vandal resistant handle screw
- Prefix H – High flow                    4-10 GPM
- Prefix M – Standard flow                1-5 GPM
- Prefix L – Low flow                        1/2 – 2-1/2 GPM

3800 less stop & check valves

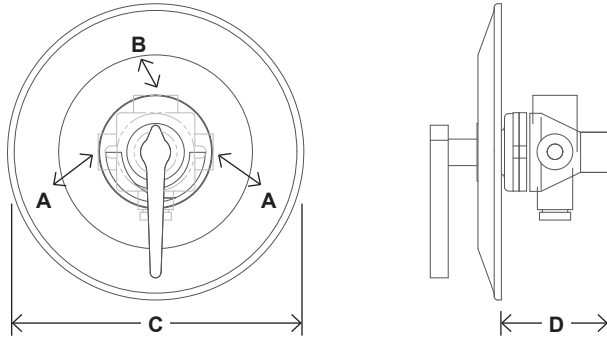

**Model 3800**  
**Eng. No. 73047**  
**(1/2" & 3/4")**

**DIMENSIONS**

Valve Number	A	N.P.T.	B	N.P.T.	C	D
3800		1/2"		1/2"	3-1/2"	4"

Dimensions are for reference purposes only. For rough-in dimensions please refer to Lawler's Revit/BIM models found at [temperedwater.com](http://temperedwater.com).

3800-SC1 with straight stop & check valves

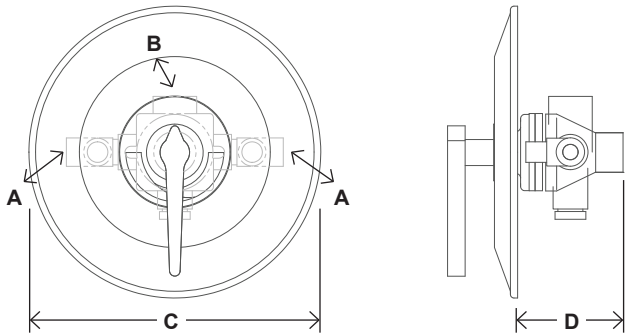

**DIMENSIONS**

Valve Number	A	N.P.T.	B	N.P.T.	C	D
3800-SC1		1/2"		1/2"	3-1/2"	4"

Dimensions are for reference purposes only. For rough-in dimensions please refer to Lawler's Revit/BIM models found at [temperedwater.com](http://temperedwater.com).

3800-SC5 with strainer in angle check valves

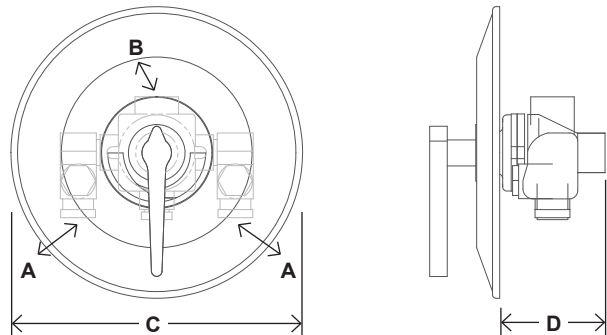

**DIMENSIONS**

Valve Number	A	N.P.T.	B	N.P.T.	C	D
3800-SC5		1/2"		1/2"	3-1/2"	4"

Dimensions are for reference purposes only. For rough-in dimensions please refer to Lawler's Revit/BIM models found at [temperedwater.com](http://temperedwater.com).